



2002601

VW SCIROCCO



INSTRUCTION SHEET

IMPORTANT! READ THESE POINTS BEFORE YOU BEGIN

- 1 This kit may be built more than one way. Decide on which version you wish to build before final assembly.
- 2 "TEST FIT" all parts before cementing. Cement all parts unless otherwise indicated by the instructions.
- 3 Use paint and cement made for styrene plastic only. Trim excess plastic from parts before joining.
- 4 Paint all sub-assemblies before attaching chrome parts.
- 5 Scrape chrome and paint away from surfaces to be cemented together.
- 6 Follow all of the numbers on the instruction sheet. Each part will have two numbers.

PART NUMBER ○ ASSEMBLY NUMBER ●

TOOLS

TWEEZERS

TWEEZERS
TO PLACE,
PICK UP
AND HOLD
SMALL PARTS.

IMPORTANT NOTE: Do not remove parts from runners until ready to use.

KNIFE

FILE

KNIFE
TO REMOVE
AND TRIM
PARTS.FILE
TO REMOVE
EXCESS
PLASTIC.

TOOTH PICK

CEMENT
USE
TOOTH PICK
PAINT
BRUSH
OR PIN
TO
APPLY IT

PAINT BRUSH

TAPE

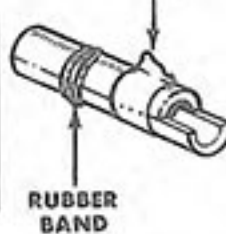
RUBBER
BANDTAPE,
RUBBER
BAND
AND
CLOTHES
PINS TO
CLAMP AND
HOLD PARTS
UNTIL THEY
ARE DRY.

PARTS LAYOUT

REMOVE BRACING

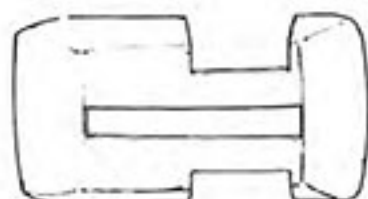
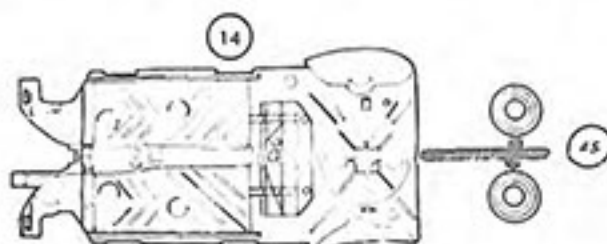
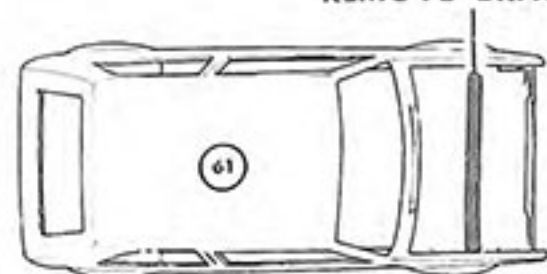
CLEAR
500

2 METAL AXLES

4 STOCK TIRES

4 CUSTOM TIRES



IMPORTANT NOTE: Layout shown below is an aid to identify parts in this kit. The part numbers do appear on actual parts. These numbers are located on the inside surface or on the attached runner of each part.

CHROME

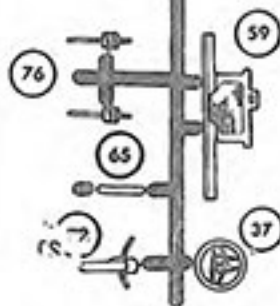
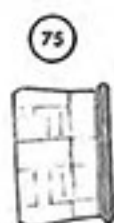
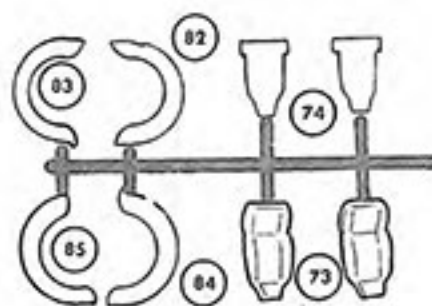
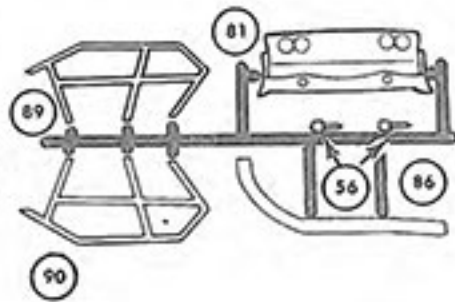
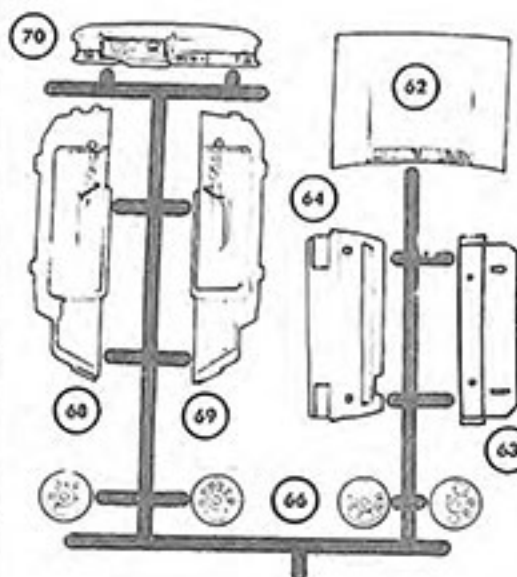
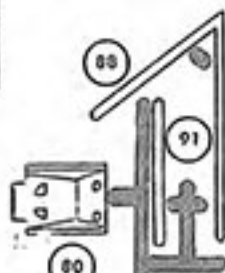
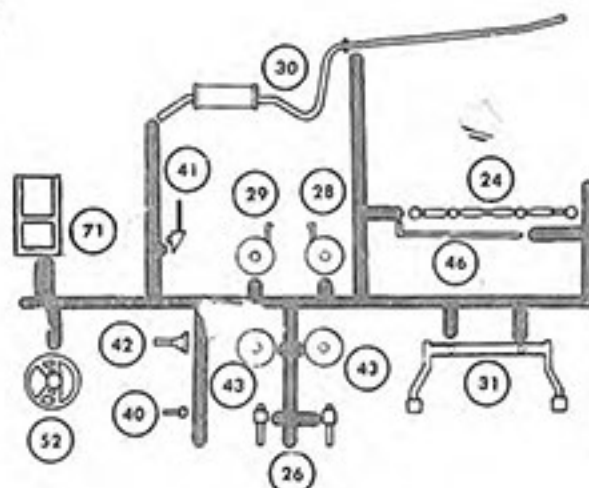
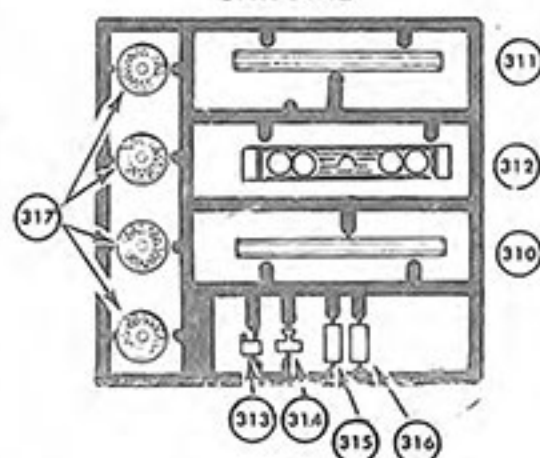

ENGINE

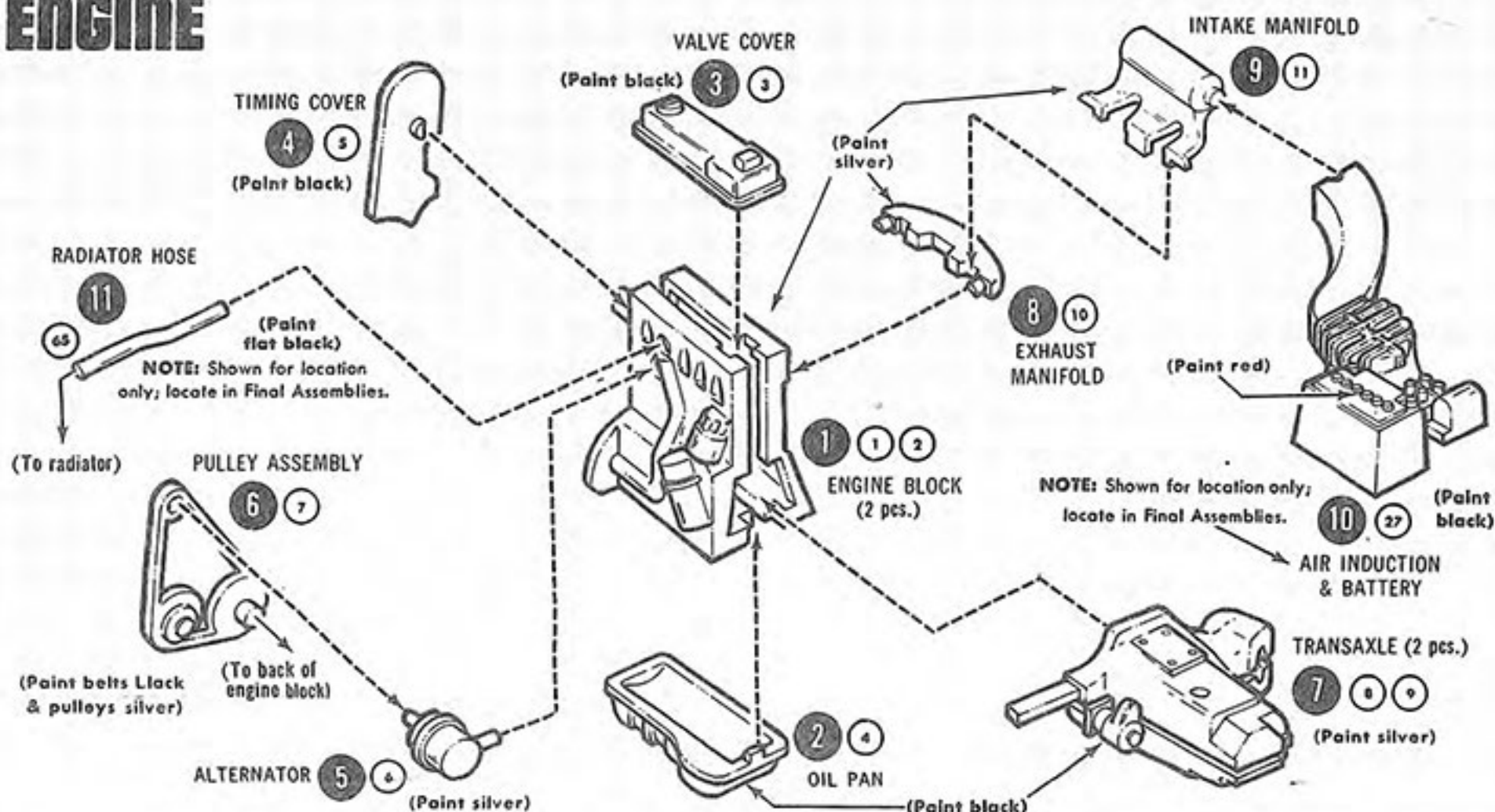

WHEELS

NOTE: Remove center of Tires.

STOCK

CUSTOM

NOTE: Remove center of Tires.

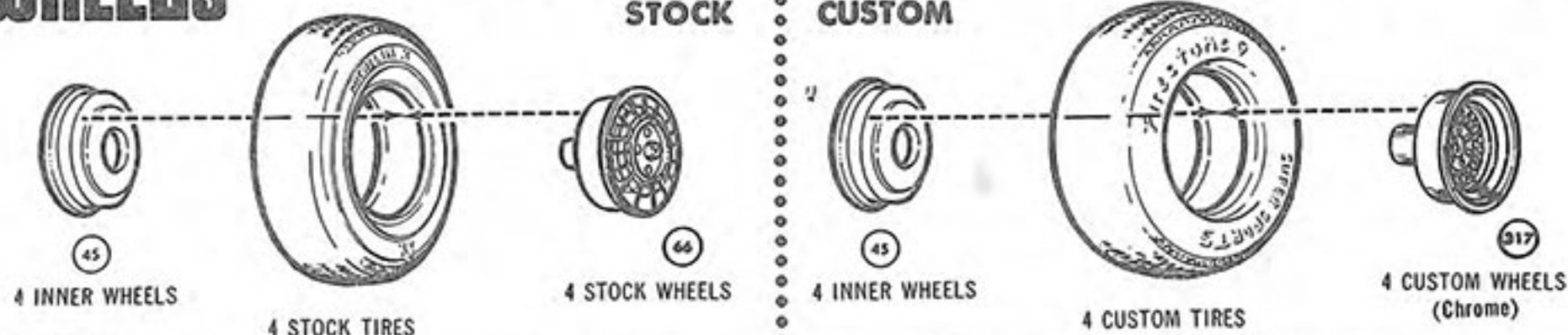

INTERIOR

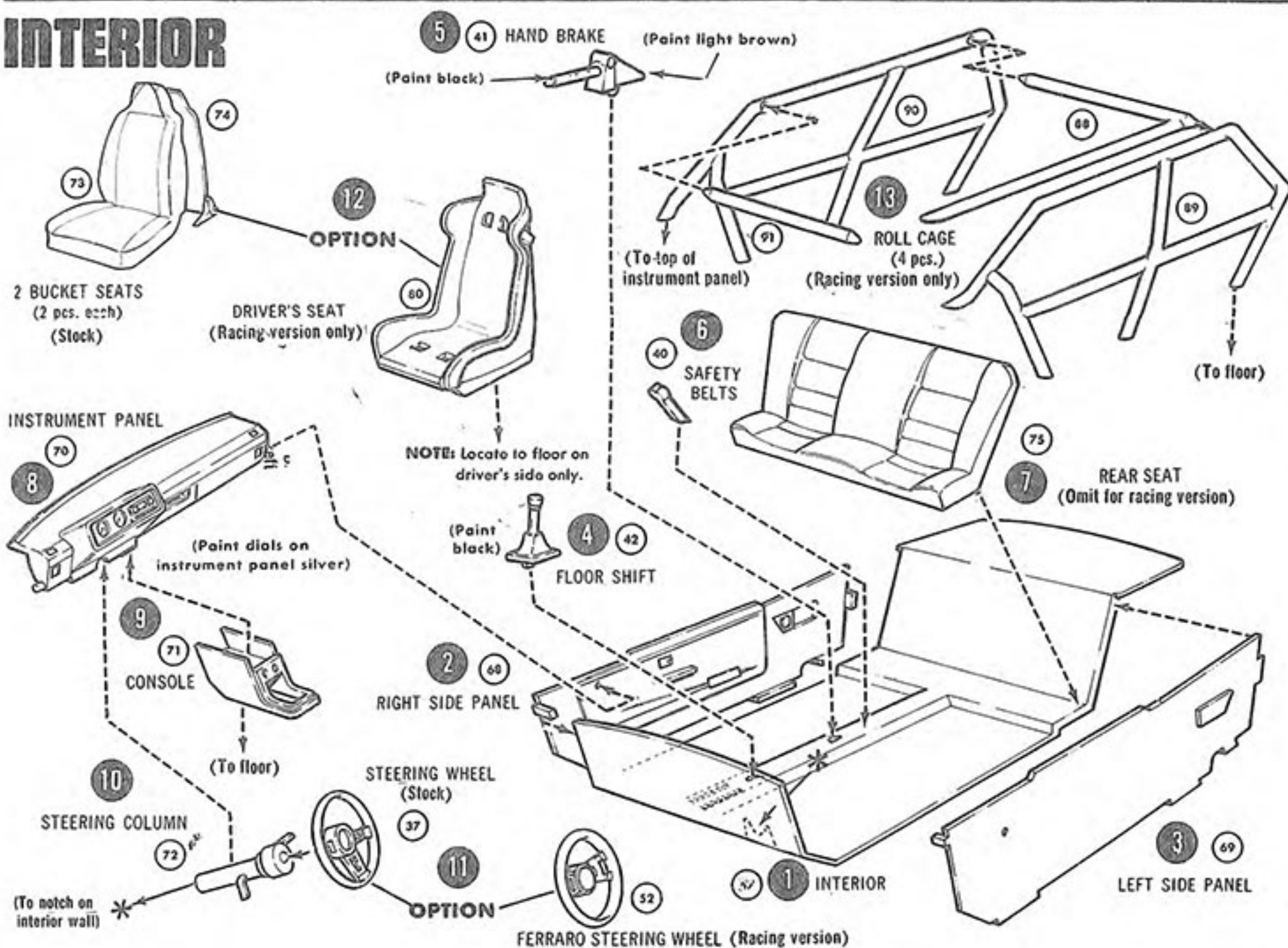

CHASSIS

SHOWN UPSIDE DOWN

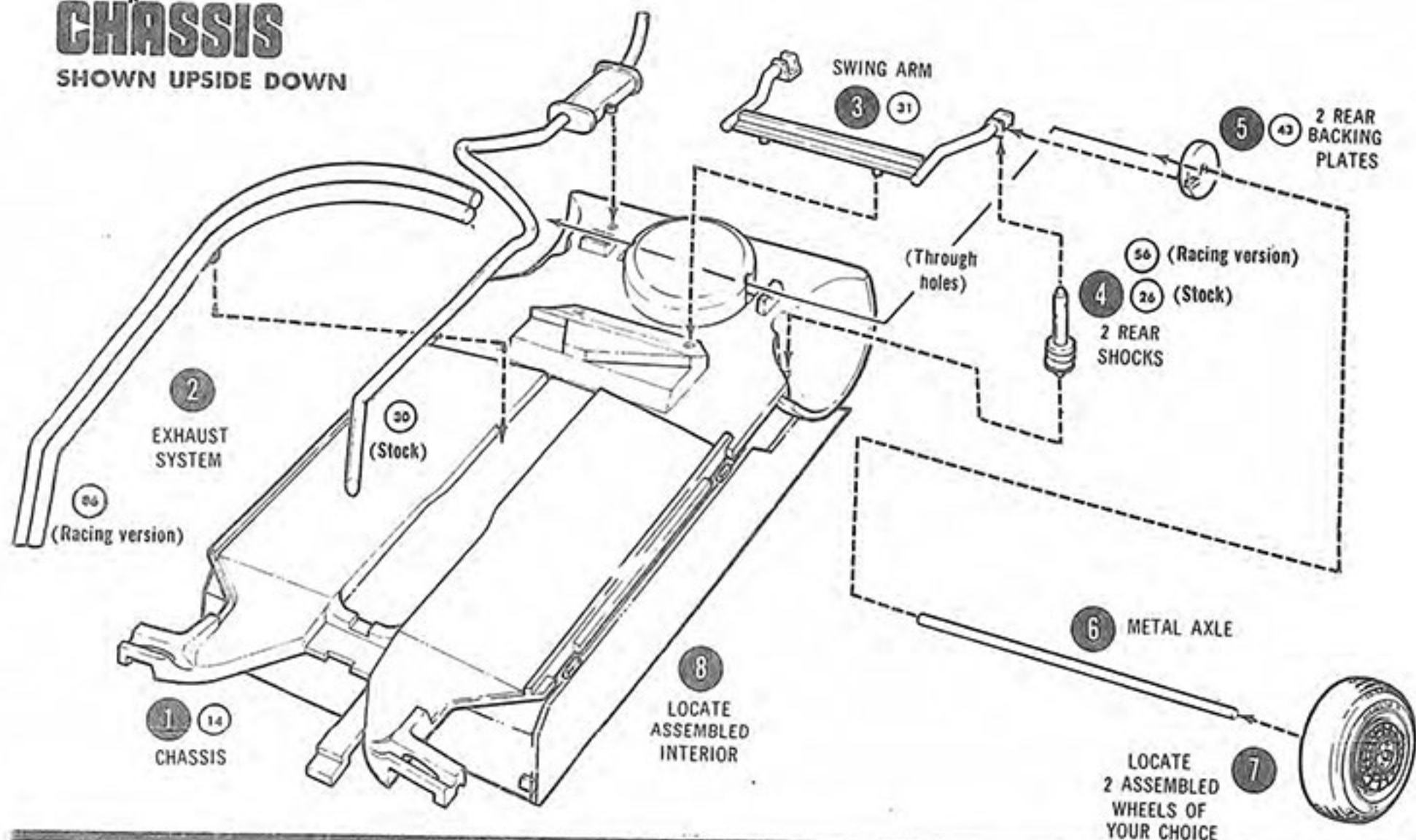

BODY

SEE BOX ART FOR ADDITIONAL PAINTING INSTRUCTIONS.

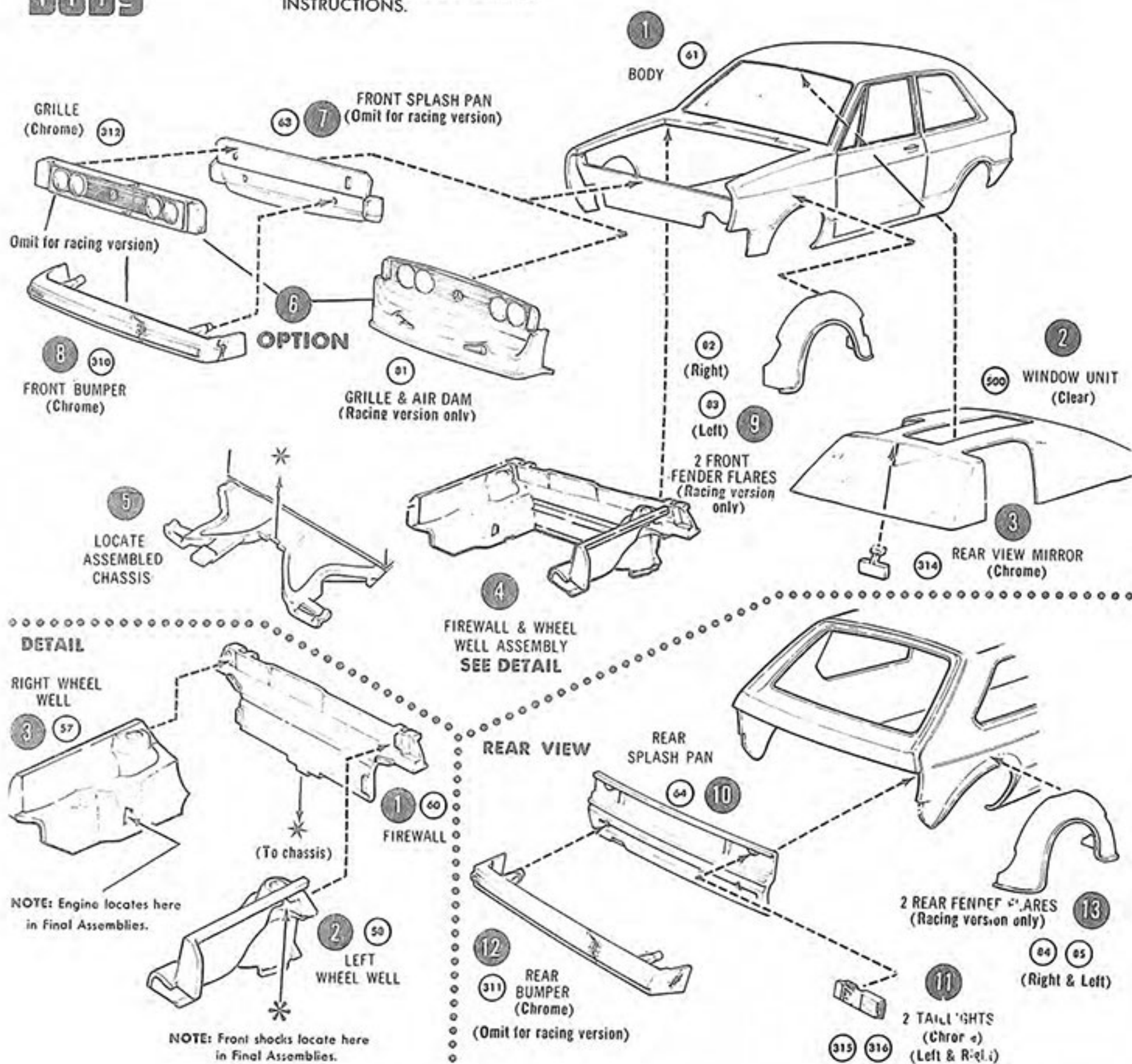

FINAL ASSEMBLIES

SEE BOX ART FOR ADDITIONAL PAINTING INSTRUCTIONS.

